

# INSTALLATION INSTRUCTIONS

## 90° ADAPTER FOR MECHANICAL SPEEDOMETERS



### QUESTIONS:

If after completely reading these instructions you have questions regarding the operation or installation of your instrument(s), please contact AutoMeter Technical Service at **866-248-6357**. You may also email us at [service@autometer.com](mailto:service@autometer.com). Additional information can also be found at <http://www.autometer.com>

### Installation

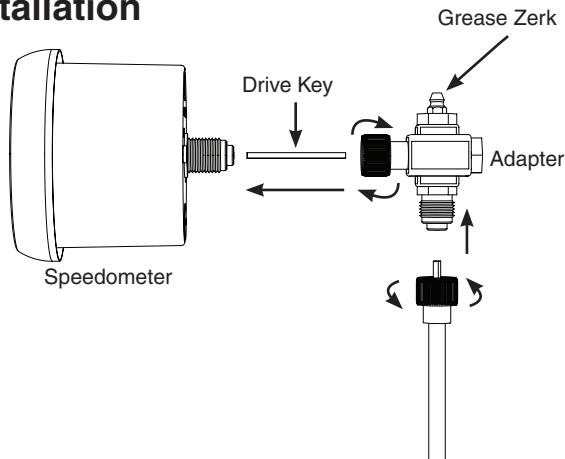

### Standard Rotation Assembly

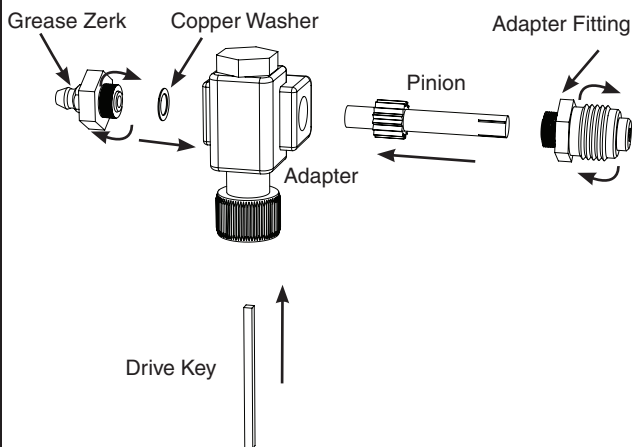

### Reverse Rotation Assembly

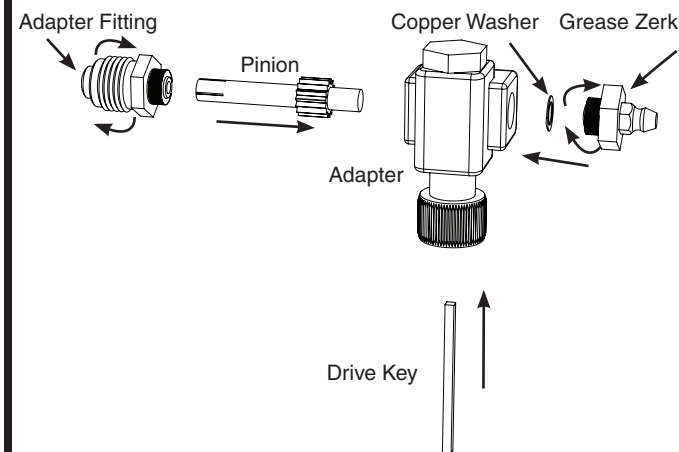

This product, in factory configuration is designed to provide a 90° (right angle) adaptation for instruments and cables featuring a 5/8 X 18 thread. This device maintains a 1:1 ratio, and standard rotation direction in this setup.

Lubricate following installation and periodically with NLGI No. 2 high performance multi purpose grease.

In standard rotation, the output wire will turn the same direction as the input.

#### Additional Installation Tips

- Examine cable routing for proper clearances to heat source, sharp edges, and ensure proper radius bend to prevent damage or binding.
- This device may also be employed on mechanical tach drive distributors such as those used on early Corvettes to accommodate clearance issues in the engine compartment or under dash.

To configure your adapter for reverse rotation, use a 5/8 (16mm) wrench to loosen the male adapter fitting and the grease zerk. Swap the fitting, pinion, copper washer and zerk to opposite sides and reassemble. Verify proper desired rotation before tightening the assembly.

Complete installation as shown in diagram and lubricate assembly before use.

In reverse rotation, the output wire turn the opposite direction of the input

#### 12 MONTH LIMITED WARRANTY

AutoMeter Products, Inc. warrants to the consumer that all AutoMeter High Performance products purchased from an Authorized AutoMeter Reseller will be free from defects in material and workmanship for a period of twelve (12) months from date of the original purchase. Products that fail within this 12 month warranty period will be repaired or replaced at AutoMeter's option, when determined by AutoMeter that the product failed due to defects in material or workmanship. This warranty is limited to the repair or replacement of parts in the AutoMeter High Performance product and the necessary labor done by AutoMeter to effect the repair or replacement of the AutoMeter High Performance product. In no event shall AutoMeter's cost to repair or replace an AutoMeter High Performance Product under this warranty exceed the original purchase price of the AutoMeter High Performance Product. Nor shall AutoMeter Products, Inc. be responsible for special, incidental or consequential damages or costs incurred due to the failure of an AutoMeter High Performance Product. This warranty applies only to the original purchaser of the AutoMeter High Performance Product and is non-transferable. This warranty also applies only to AutoMeter High Performance Products purchased from an Authorized AutoMeter Reseller. All implied warranties shall be limited in duration to the said 12 month warranty period. Breaking the instrument seal, improper use or installation, accident, water damage, abuse, unauthorized repairs or alterations voids this warranty. AutoMeter disclaims any liability for consequential damages due to the breach of any written or implied warranty on all products manufactured by AutoMeter Products, Inc. For a comprehensive listing of Un-Authorized AutoMeter Resellers please visit [www.autometer.com/autometerlocator/index/unauthorized](http://www.autometer.com/autometerlocator/index/unauthorized).

#### SERVICE

For service send your product to AutoMeter in a well packed shipping carton. Please include a note explaining what the problem is along with your phone number. If you are sending product back for Warranty adjustment, you must include a copy (or original) of your sales receipt from the place of purchase.

FOR SERVICE SEND TO: **AUTOMETER PRODUCTS, INC.** 413 W. Elm St., Sycamore, IL 60178 USA (866) 248-6357 • International: (815) 895-8141

Email us at [service@autometer.com](mailto:service@autometer.com)